

INDEX

SHEET NO.	SUBJECT
1	Index and General Notes
2	Traffic Control Signs
3	Traffic Control Signs
4	Traffic Control Sign Design Details
5	Traffic Control Sign Design Details
6	Traffic Control Sign Design Details
7	Temporary Panel Sign Post Installation
8	Temporary Panel Sign Post Selection and Connection Details

This sheet replaces Standard Drawing E 801-TCSN-01

GENERAL NOTES:

1. The minimum vertical and horizontal clearances for construction signs shall be as shown on Standard Drawing E 801-TCDV-06.
2. See Standard Drawing E 801-TCDV-09 for U-Channel Steel Post Splice Detail.

INDIANA DEPARTMENT OF TRANSPORTATION

INDEX AND GENERAL NOTES



XW20-1
XW20-1-A



XW21-8
XW21-8-A



XW21-Y8b
XW21-Y8b-A



XW2-6b
XW2-6b-A
XW2-6b-B



XW2-6a
XW2-6a-A
XW2-6a-B



XW26-1

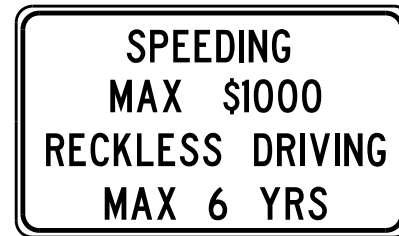

XW2-6
XW2-6-A

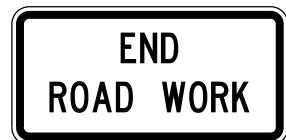

XG20-2



XW3-4S



XG20-1

This sheet replaces Standard Drawing E 801-TCSN-02

NOTES:

- ① Sign shall be removed, covered, or turned to face away from the roadway during non-working hours.
- ② Sign may be ordered to read "500 FT" or "1000 FT" in place of the word "AHEAD". Such signs may be used in place of or in conjunction with the indicated sign.
- ③ Shaded text indicates message content that must be varied to reflect site conditions.

INDIANA DEPARTMENT OF TRANSPORTATION

TRAFFIC CONTROL SIGNS



XW20-YWR(A)



XW20-YWR(B)



XW20-YWR(C)



XM4-9d

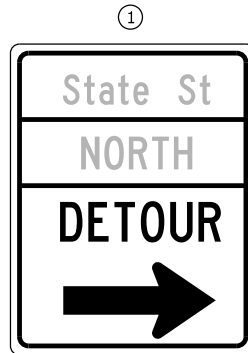

XM4-9e



XW9-7



E5-1



E5-2



E5-2a

This sheet replaces Standard Drawing E 801-TCSN-03

NOTE:

- ① Shaded text indicates message content that must be varied to reflect site conditions.

INDIANA DEPARTMENT OF TRANSPORTATION

TRAFFIC CONTROL SIGNS

This sheet replaces Standard Drawing E 801-TCSN-04

NOTES:

- ① Spacing between letters of this word or line shall be reduced by this percentage as shown in the FHWA document, *Standard Highway Signs*.
2. All dimensions are in inches.
3. The minimum depth for wood or steel posts shall be 4 ft.

SIGN NUMBER	IMUTCD CODE	SIGN MESSAGE	POST DESIGN TYPE			SIGN SIZE	SIGN COLOR		BORDER WIDTH	MARGIN WIDTH	LETTER HEIGHT SERIES - LINE 1	LETTER HEIGHT SERIES - LINE 2	LETTER HEIGHT SERIES - LINE 3	WORD OR LINE	PCT.	CORNER RADIUS	NO. OF POSTS	
			4 X 4 WOOD	U-CHANNEL	SQUARE POST		BACKGROUND	COPY									1	2
R2-1	R2-1	Speed Limit _____	*	A	1	24 X 30	White	Black			See FHWA publication Standard Highway Signs for fabrication details						X	
R2-1-B	R2-1	Speed Limit _____	*	B	2	48 X 60	White	Black			See FHWA publication Standard Highway Signs for fabrication details							X
R3-2-A (R or L)	R3-2	(Movement Prohibition)	*	A	1	30 X 30	White	Black			See FHWA publication Standard Highway Signs for fabrication details						X	
R3-2-C (R or L)	R3-2	(Movement Prohibition)	*	B	2	48 X 48	White	Black			See FHWA publication Standard Highway Signs for fabrication details							X
R4-1	R4-1	Do Not Pass	*	A	1	24 X 30	White	Black			See FHWA publication Standard Highway Signs for fabrication details						X	
R4-1-B	R4-1	Do Not Pass	*	B	2	48 X 60	White	Black			See FHWA publication Standard Highway Signs for fabrication details							X
R5-1-A	R5-1	Do Not Enter	*	A	1	36 X 36	Red	White			See FHWA publication Standard Highway Signs for fabrication details						X	
R5-1-B	R5-1	Do Not Enter	*	B	2	48 X 48	Red	White			See FHWA publication Standard Highway Signs for fabrication details							X
R6-1 (R or L)	R6-1	One Way (Inside White Arrow)	*	A	1	36 X 12	White	Black			See FHWA publication Standard Highway Signs for fabrication details						X	
R6-2-A (R or L)	R6-2	One Way (Above White Arrow)	*	A	1	24 X 30	Black & White	Black			See FHWA publication Standard Highway Signs for fabrication details						X	
R9-8	R9-8	Pedestrian Crosswalk	*	A	1	36 X 18	White	Black			See FHWA publication Standard Highway Signs for fabrication details						X	
R9-9	R9-9	Sidewalk Closed	*	A	1	24 X 12	White	Black			See FHWA publication Standard Highway Signs for fabrication details						X	
R9-10	R9-10	Sidewalk Closed Use Other Side	*	A	1	24 X 12	White	Black			See FHWA publication Standard Highway Signs for fabrication details						X	
R9-11	R9-11	Sidewalk Closed Ahead Cross Here	*	A	1	24 X 18	White	Black			See FHWA publication Standard Highway Signs for fabrication details						X	
R9-11a	R9-11a	Sidewalk Closed Cross Here	*	A	1	24 X 12	White	Black			See FHWA publication Standard Highway Signs for fabrication details						X	
R9-12	R9-12	Bike Lane Closed	*	A	1	24 X 12	White	Black			See FHWA publication Standard Highway Signs for fabrication details						X	
R11-2	R11-2	Road Closed	*	B	1	48 X 30	White	Black			See FHWA publication Standard Highway Signs for fabrication details							X
R11-3	R11-3	Road Closed - Local Traffic Only	*	B	2	60 X 30	White	Black			See FHWA publication Standard Highway Signs for fabrication details							X
R11-4	R11-4	Road Closed to Thru Traffic	*	B	2	60 X 30	White	Black			See FHWA publication Standard Highway Signs for fabrication details							X
R12-1	R12-1	Weight Limit _____ Tons	*	A	1	24 X 30	White	Black			See FHWA publication Standard Highway Signs for fabrication details						X	
R12-1-A	R12-1	Weight Limit _____ Tons	-	B	2	36 X 48	White	Black			See FHWA publication Standard Highway Signs for fabrication details							X
S4-4	S4-4	When Flashing Plaque	*	-	-	48 X 20	White	Black			See FHWA publication Standard Highway Signs for fabrication details						-	-
XW1-1-A (R or L)	W1-1	(Turn Symbol)	*	A	1	36 X 36	Orange	Black			See FHWA publication Standard Highway Signs for fabrication details							X
XW1-1-B (R or L)	W1-1	(Turn Symbol)	*	B	2	48 X 48	Orange	Black			See FHWA publication Standard Highway Signs for fabrication details						X	
XW1-2-A (R or L)	W1-2	(Curve Symbol)	*	A	1	36 X 36	Orange	Black			See FHWA publication Standard Highway Signs for fabrication details						X	
XW1-2-B (R or L)	W1-2	(Curve Symbol)	*	B	2	48 X 48	Orange	Black			See FHWA publication Standard Highway Signs for fabrication details							X
XW1-3-A (R or L)	W1-3	(Reverse Turn Symbol)	*	A	1	36 X 36	Orange	Black			See FHWA publication Standard Highway Signs for fabrication details							X
XW1-3-B (R or L)	W1-3	(Reverse Turn Symbol)	*	B	2	48 X 48	Orange	Black			See FHWA publication Standard Highway Signs for fabrication details						X	
XW1-4-A (R or L)	W1-4	(Reverse Curve Symbol)	*	A	1	36 X 36	Orange	Black			See FHWA publication Standard Highway Signs for fabrication details							X
XW1-4-B (R or L)	W1-4	(Reverse Curve Symbol)	*	B	2	48 X 48	Orange	Black			See FHWA publication Standard Highway Signs for fabrication details						X	
XW1-6	W1-6	(Single Headed Arrow)	*	B	1	48 X 24	Orange	Black			See FHWA publication Standard Highway Signs for fabrication details						X	
XW1-6-A	W1-6	(Single Headed Arrow)	*	B	2	60 X 30	Orange	Black			See FHWA publication Standard Highway Signs for fabrication details							X
XW2-6	XW2-6	Worksite Added Penalty	*	B	2	60 X 36	Orange	Black	7/8	5/8	5 - Series C	5 - Series C	5 - Series C	5 - Series C		2 1/4	X	
XW2-6-A	XW2-6	Worksite Added Penalty	*	B	2	78 X 42	Orange	Black	7/8	5/8	6 - Series D	6 - Series D	6 - Series D	6 - Series D		2 1/4	X	
XW2-6a	XW2-6a	Speeding Max \$1000	*	A	1	30 X 30	Orange	Black	3/4	1/2	4 - Series C	4 - Series C				1 7/8	X	
XW2-6a-A	XW2-6a	Speeding Max \$1000	*	A	1	36 X 36	Orange	Black	7/8	5/8	5 - Series C	5 - Series C				2 1/4	X	
XW2-6a-B	XW2-6a	Speeding Max \$1000	*	B	2	48 X 48	Orange	Black	1 1/4	3/4	6 - Series D	6 - Series D				3	X	
XW2-6b	XW2-6b	Reckless Driving Max 6 Yrs	*	A	1	30 X 30	Orange	Black	3/4	1/2	4 - Series C	4 - Series C				1 7/8	X	
XW2-6b-A	XW2-6b	Reckless Driving Max 6 Yrs	*	A	1	36 X 36	Orange	Black	7/8	5/8	5 - Series C	5 - Series C				2 1/4	X	
XW2-6b-B	XW2-6b	Reckless Driving Max 6 Yrs	*	B	2	48 X 48	Orange	Black	1 1/4	3/4	6 - Series D	6 - Series D				3	X	

*Wood post permitted.

INDIANA DEPARTMENT OF TRANSPORTATION

TRAFFIC CONTROL SIGN DESIGN DETAILS

This sheet replaces Standard Drawing E 801-TCSN-05

① ①

NOTES:

- ① Spacing between letters of this word or line shall be reduced by this percentage as shown in the FHWA document, *Standard Highway Signs*.
2. All dimensions are in inches.
3. The minimum depth for wood or steel posts shall be 4 ft.

SIGN NUMBER	IMUTCD CODE	SIGN MESSAGE	POST DESIGN TYPE			SIGN SIZE	SIGN COLOR		BORDER WIDTH	MARGIN WIDTH	LETTER HEIGHT SERIES - LINE 1	LETTER HEIGHT SERIES - LINE 2	LETTER HEIGHT SERIES - LINE 3	WORD OR LINE	PCT.	CORNER RADIUS	NO. OF POSTS	
			4 X 4 WOOD	U-CHANNEL	SQUARE POST		BACKGROUND	COPY									1	2
XW3-4S	-	Overhead Sign Installation	*	B	2	60 X 24	Orange	Black	1/2	3/8	6 - Series C	6 - Series C				1 1/2		X
XW3-5-A	W3-5	(Reduced Speed Limit Ahead)	*	A	1	36 X 36	Orange	Black			See FHWA publication Standard Highway Signs for fabrication details							X
XW3-5-B	W3-5	(Reduced Speed Limit Ahead)	*	B	2	48 X 48	Orange	Black			See FHWA publication Standard Highway Signs for fabrication details							X
XW3-5a-A	W3-5	(Reduced Speed Limit Ahead)	*	A	1	36 X 36	Orange	Black			See FHWA publication Standard Highway Signs for fabrication details							X
XW3-5a-B	W3-5	(Reduced Speed Limit Ahead)	*	B	2	48 X 48	Orange	Black			See FHWA publication Standard Highway Signs for fabrication details							X
XW4-2 (R or L)	W4-2	(Lane Ends Merge Symbol)	*	A	1	36 X 36	Orange	Black			See FHWA publication Standard Highway Signs for fabrication details							X
XW4-2-A (R or L)	W4-2	(Lane Ends Merge Symbol)	*	B	2	48 X 48	Orange	Black			See FHWA publication Standard Highway Signs for fabrication details							X
XW6-2a-A	W6-2	(Divided Highway Ends Symbol)	*	A	1	36 X 36	Orange	Black			See FHWA publication Standard Highway Signs for fabrication details							X
WX6-2a-B	W6-2	(Divided Highway Ends Symbol)	*	B	2	48 X 48	Orange	Black			See FHWA publication Standard Highway Signs for fabrication details							X
XW6-3-B	W6-3	(Two Way Traffic Symbol)	*	B	2	48 X 48	Orange	Black			See FHWA publication Standard Highway Signs for fabrication details							X
XW8-1-A	W8-1	Bump	*	A	1	36 X 36	Orange	Black			See FHWA publication Standard Highway Signs for fabrication details							X
XW8-1-B	W8-1	Bump	*	B	2	48 X 48	Orange	Black			See FHWA publication Standard Highway Signs for fabrication details							X
XW8-2-A	W8-2	Dip	*	A	1	36 X 36	Orange	Black			See FHWA publication Standard Highway Signs for fabrication details							X
XW8-2-B	W8-2	Dip	*	B	2	48 X 48	Orange	Black			See FHWA publication Standard Highway Signs for fabrication details							X
XW8-3-A	W8-3	Pavement Ends	*	A	1	36 X 36	Orange	Black			See FHWA publication Standard Highway Signs for fabrication details							X
XW8-4-A	W8-4	Soft Shoulder	*	A	1	36 X 36	Orange	Black			See FHWA publication Standard Highway Signs for fabrication details							X
XW8-4-B	W8-4	Soft Shoulder	*	B	2	48 X 48	Orange	Black			See FHWA publication Standard Highway Signs for fabrication details							X
XW8-6-A	W8-6	Truck Crossing	*	A	1	36 X 36	Orange	Black			See FHWA publication Standard Highway Signs for fabrication details							X
XW8-6-B	W8-6	Truck Crossing	*	B	2	48 X 48	Orange	Black			See FHWA publication Standard Highway Signs for fabrication details							X
XW9-1-A (R or L)	W9-1	Lane Ends	*	A	1	36 X 36	Orange	Black			See FHWA publication Standard Highway Signs for fabrication details							X
XW9-1-B (R or L)	W9-1	Lane Ends	*	B	2	48 X 48	Orange	Black			See FHWA publication Standard Highway Signs for fabrication details							X
XW9-2-B (R or L)	W9-2	Lane Ends Merge	*	B	2	48 X 48	Orange	Black			See FHWA publication Standard Highway Signs for fabrication details							X
XW9-7	W9-7	Right Lane for Exit Only	6 X 6	-	-	132 X 72	Orange	Black			See FHWA publication Standard Highway Signs for fabrication details							X
XW12-1-C	W12-1	Double Arrow	*	B	2	48 X 48	Orange	Black			See FHWA publication Standard Highway Signs for fabrication details							X
XW13-1-A	W13-1	Advisory Speed Plaque	*	A	1	36 X 36	Orange	Black			See FHWA publication Standard Highway Signs for fabrication details						-	-
XW20-1-A	W20-1	Road Work Ahead	*	A	1	36 X 36	Orange	Black			See FHWA publication Standard Highway Signs for fabrication details							X
XW20-1	W20-1	Road Work Ahead	*	B	2	48 X 48	Orange	Black			See FHWA publication Standard Highway Signs for fabrication details							X
XW20-2	W20-2	Detour Ahead	*	B	2	48 X 48	Orange	Black			See FHWA publication Standard Highway Signs for fabrication details							X
XW20-3	W20-3	Road Closed Ahead	*	B	2	48 X 48	Orange	Black			See FHWA publication Standard Highway Signs for fabrication details							X
XW20-4	W20-4	One Lane Road Ahead	*	B	2	48 X 48	Orange	Black			See FHWA publication Standard Highway Signs for fabrication details							X
XW20-5 (R, C, or L)	W20-5	Lane Closed Ahead	*	B	2	48 X 48	Orange	Black			See FHWA publication Standard Highway Signs for fabrication details							X
XW20-7-A	W20-7	Flagger Symbol	*	B	2	48 X 48	Orange	Black			See FHWA publication Standard Highway Signs for fabrication details							X
XW20-YWR(A)	-	Wide Load Restriction Miles	*	B	2	48 X 48	Orange	Black	1 1/4	3/4	6 - Series D	6 - Series D	6 - Series D			3		X
XW20-YWR(B)	-	Wide Load Over ft Must Exit	*	B	2	48 X 48	Orange	Black	1 1/4	3/4	6 - Series C	6 - Series C	6 - Series C	6 - Series C		3		X
XW20-YWR(C)	-	No Loads Over ft Wide	*	B	2	48 X 48	Orange	Black	1 1/4	3/4	6 - Series D	6 - Series D	6 - Series D	6 - Series D		3		X

*Wood post permitted.

INDIANA DEPARTMENT OF TRANSPORTATION

TRAFFIC CONTROL SIGN DESIGN DETAILS

This sheet replaces Standard Drawing E 801-TCSN-06

NOTES:

- ① Spacing between letters of this word or line shall be reduced by the percentage shown in the FHWA document, *Standard Highway Signs*.
2. All dimensions are in inches.
3. The minimum depth for wood or steel posts shall be 4 ft.

SIGN NUMBER	IMUTCD CODE	SIGN MESSAGE	POST DESIGN TYPE			SIGN SIZE	SIGN COLOR BACKGROUND	COPY	BORDER WIDTH	MARGIN WIDTH	LETTER HEIGHT SERIES - LINE 1	LETTER HEIGHT SERIES - LINE 2	LETTER HEIGHT SERIES - LINE 3	WORD OR LINE	PCT.	CORNER RADIUS	NO. OF POSTS	
			4 X 4 WOOD	U-CHANNEL	SQUARE POST												1	2
XW21-1-A	W21-1	Workers Symbol	*	A	1	36 X 36	Orange	Black			See FHWA publication Standard Highway Signs for fabrication details							X
XW21-2	W21-2	Fresh Oil	*	A	1	30 X 30	Orange	Black			See FHWA publication Standard Highway Signs for fabrication details						X	
XW21-2-A	W21-2	Fresh Oil	*	A	1	36 X 36	Orange	Black			See FHWA publication Standard Highway Signs for fabrication details							X
XW21-3-A	W21-3	Road Machinery Ahead	*	B	2	48 X 48	Orange	Black			See FHWA publication Standard Highway Signs for fabrication details							X
XW21-5-A	W21-5	Shoulder Work	*	A	1	36 X 36	Orange	Black			See FHWA publication Standard Highway Signs for fabrication details							X
XW21-6-A	W21-6	Survey Crew	*	A	1	36 X 36	Orange	Black			See FHWA publication Standard Highway Signs for fabrication details							X
XW21-7	W21-7	Utility Work Ahead	*	A	1	36 X 36	Orange	Black			See FHWA publication Standard Highway Signs for fabrication details							X
XW21-7-A	W21-7	Utility Work Ahead	*	B	2	48 X 48	Orange	Black			See FHWA publication Standard Highway Signs for fabrication details							X
XW21-Y8b	-	Mowing Next X Miles	*	A	1	36 X 36	Orange	Black	3/4	1/2	6 - Series C	6 - Series C	6 - Series C			2 1/4	X	
XW21-Y8b-A	-	Mowing Next X Miles	*	B	2	48 X 48	Orange	Black	1 1/4	3/4	8 - Series C	8 - Series C	8 - Series C			3	X	
XW21-8	W21-8	Mowing Ahead	*	A	1	36 X 36	Orange	Black			See FHWA publication Standard Highway Signs for fabrication details							X
XW21-8-A	W21-8	Mowing Ahead	*	B	2	48 X 48	Orange	Black			See FHWA publication Standard Highway Signs for fabrication details							X
XW26-1	W26-1	Watch for Stopped Traffic	*	B	2	48 X 48	Orange	Black			See FHWA publication Standard Highway Signs for fabrication details							X
XG20-1	G20-1	Road Work Next ____ Miles	*	B	1	48 X 24	Orange	Black			See FHWA publication Standard Highway Signs for fabrication details							X
XG20-2	G20-2	End Road Work	*	B	1	48 X 24	Orange	Black			See FHWA publication Standard Highway Signs for fabrication details							X
XG20-4	G20-4	Pilot Car Follow Me	-	-	-	36 X 18	Orange	Black			See FHWA publication Standard Highway Signs for fabrication details						-	-
XG20-5	-	(Route Number or Lane Closed On or After ____)	*	B	2	60 X 36	Orange	Black	3/4	1/2	6 - Series C	6 - Series C	6 - Series C			2 1/4	X	
XG20-5P	XG20-5P	Worksite Plaque	-	-	-	48 X 16	Orange	Black	1/2	3/8	8 - Series C					1 1/2	-	
XW20-6	-	Lane Restrictions On or After ____	*	B	2	60 X 36	Orange	Black	3/4	1/2	5 - Series C	5 - Series C	4 - Series C			1 7/8	X	
XW20-6A	-	Lane Restrictions On or After ____	*	B	2	72 X 36	Orange	Black	7/8	5/8	6 - Series C	6 - Series C	5 - Series C			2 1/4	X	
XM4-9 (R or L)	M4-9	Detour (Above Black Arrow)	*	A	1	30 X 24	Orange	Black			See FHWA publication Standard Highway Signs for fabrication details						X	
XM4-9-B (R or L)	M4-9	Detour (Above Black Arrow)	*	B	2	48 X 36	Orange	Black			See FHWA publication Standard Highway Signs for fabrication details							X
M4-Y9	-	Temporary Path with Arrow	*	A	1	24 X 12	Orange	Black	5/8	3/8	3 - Series C	3 - Series C (Arrow is 6x4)		2		1 1/2	X	
XM4-Y9d	-	____ St / Detour Arrow	*	B	2	L X 36	Orange	Black	1/2	3/8	4 - Series C	6 - Series C		1	30	1 1/2	X (L ≤ 42)	
XM4-Y9e	-	____ St / Direction / Detour Arrow	*	B	2	L X 48	Orange	Black	1/2	3/8	4 - Series C	6 - Series C	6 - Series C	1	30	1 1/2	X (L ≤ 36)	
XM4-10 (R or L)	M4-10	Detour (Inside Orange Arrow)	*	B	1	48 X 18	Black & Orange	Black			See FHWA publication Standard Highway Signs for fabrication details							X
E5-2a	-	Exit Closed	*	B	2	48 X 36	Orange	Black			See FHWA publication Standard Highway Signs for fabrication details							X
E5-2	-	Exit Open	*	B	2	48 X 36	Orange	Black			See FHWA publication Standard Highway Signs for fabrication details							X
E5-1c	E5-Y1c	Exit (Above Arrow)	6x6	B	2	48 X 84	Green	White	1 1/2	0	12 - Series E	18 - Series E	(Arrow is 10-13.4)			6	X	

*Wood post permitted.

INDIANA DEPARTMENT OF TRANSPORTATION

TRAFFIC CONTROL SIGN DESIGN DETAILS

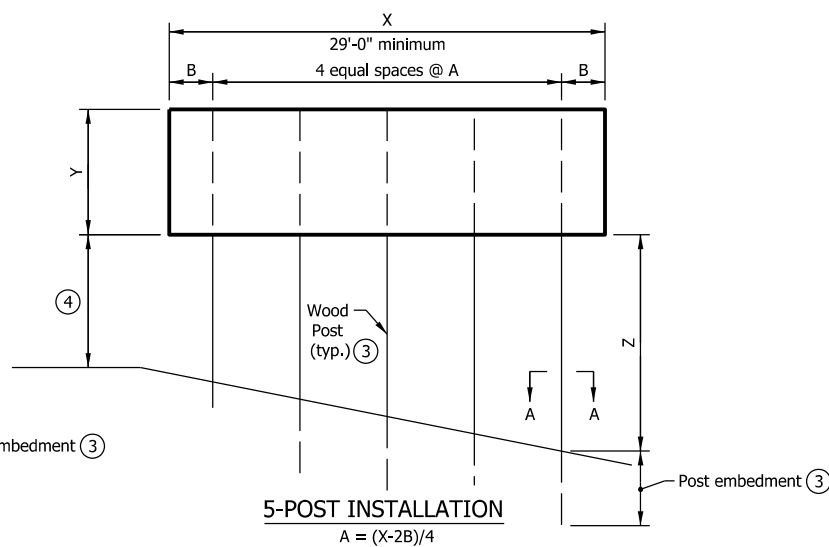
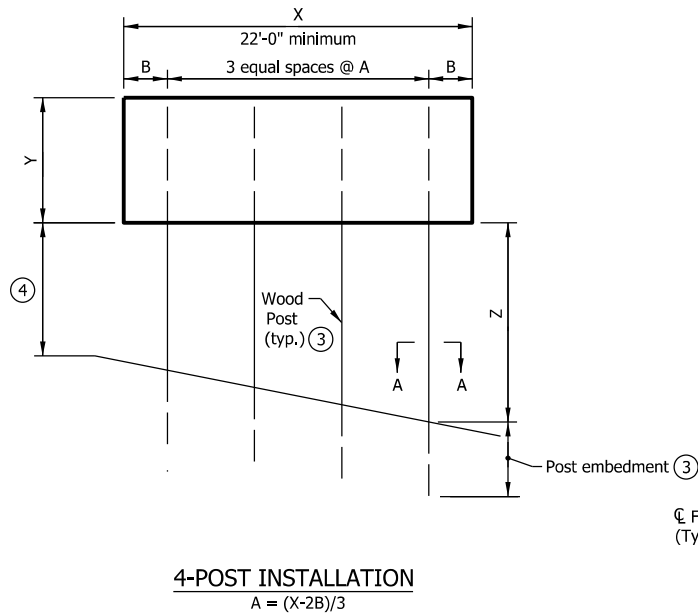
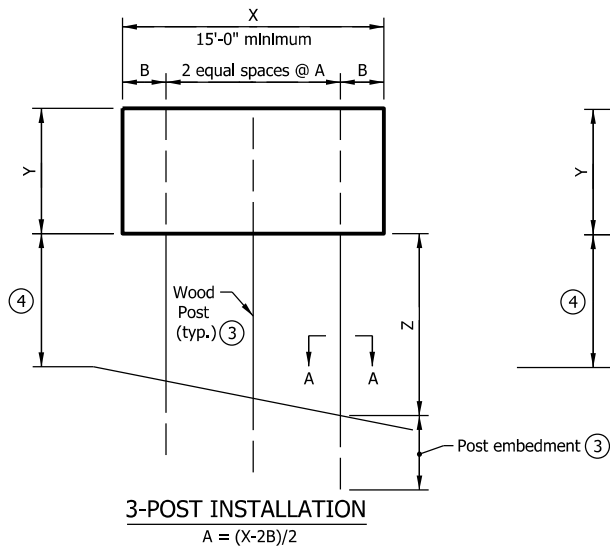
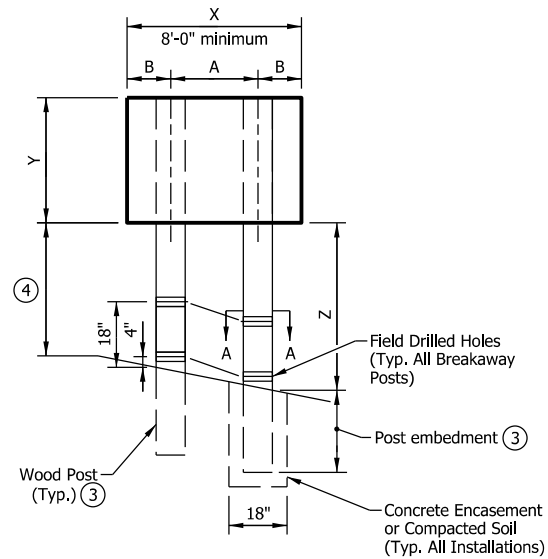

This sheet replaces Standard Drawing E 801-TCSN-07

NOTES:

1. The minimum post spacing (A) shall be 7'-0" and the maximum spacing shall be 15'-0". The minimum overhang width (B) shall be 6 inches and the maximum width shall be $A/2$.
2. X and Y dimensions shall be in increments of 6 inches. The Z dimension shall be rounded up to the nearest 6 inch increment.
3. For post selection and post embedment depth, see table on Standard Drawing E 801-TCSN-08.
4. The minimum vertical clearance shall be as shown on Standard Drawing E 801-TCOV-06.
5. Field drilled holes through post shall be parallel to sign face.

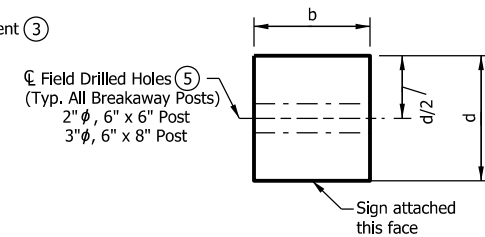

INDIANA DEPARTMENT OF TRANSPORTATION

TEMPORARY PANEL SIGN
 POST INSTALLATION

This sheet replaces Standard Drawing E 801-TCSN-08

NOTES:

1. Post material shall be dense southern pine select natural.
2. See Standard Drawing E 801-TCSN-07 for X, Y and Z dimensions.
3. The table is valid for dimensions within the following range:
Sign Width (X) between 8'-0" and 45'-0"
Sign Height (Y) between 4'-0" and 20'-0"
Clear Height (Z) between 7'-0" and 15'-0"
- ④ The length of the connector shall be equal to the sign height Y.
- ⑤ Non-breakaway posts shall be placed outside the clearzone or behind barrier or guardrail. The edge of the panel sign adjacent to traffic shall be at least 6 feet from the face of the barrier or guardrail.
- ⑥ At exterior posts, the Angle Connector shall be installed on the outside face of the post.

TEMPORARY PANEL SIGN WOOD POST SELECTION TABLE						
Post Description	Nominal Post Size (b x d)	(X * Y * Z) in ft ³ (Maximum)				Post Embedment
		Number of Posts				
		2	3	4	5	ft
Breakaway Post	6" x 6"	363	681	1000	1318	5
	6" x 8"	479	899	1319	1739	6
Non-Breakaway Post ⑤	6" x 6"	389	730	1071	1412	5
	6" x 8"	615	1154	1693	2232	6
	8" x 8"	755	1416	2078	2739	7
	8" x 10"	1007	1941	2848	3754	8
	10" x 10"	1279	2399	3519	4639	9

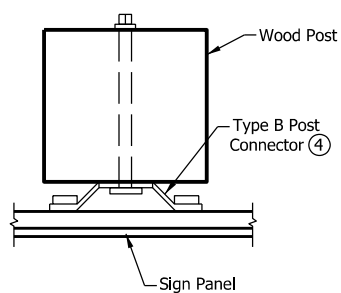

TYPE B POST CONNECTION

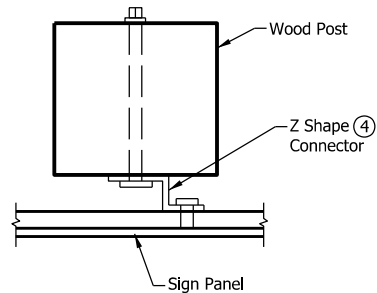

Z SHAPE CONNECTION

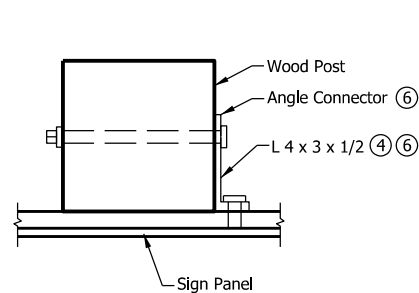

ANGLE SHAPE CONNECTION

INDIANA DEPARTMENT OF TRANSPORTATION

TEMPORARY PANEL SIGNS
WOOD POST SELECTION TABLE